



LEGEND:

EXISTING CYCLE ROUTE 

EXISTING ON ROAD CYCLE ROUTE 

PROPOSED PEDESTRIAN ROUTE 

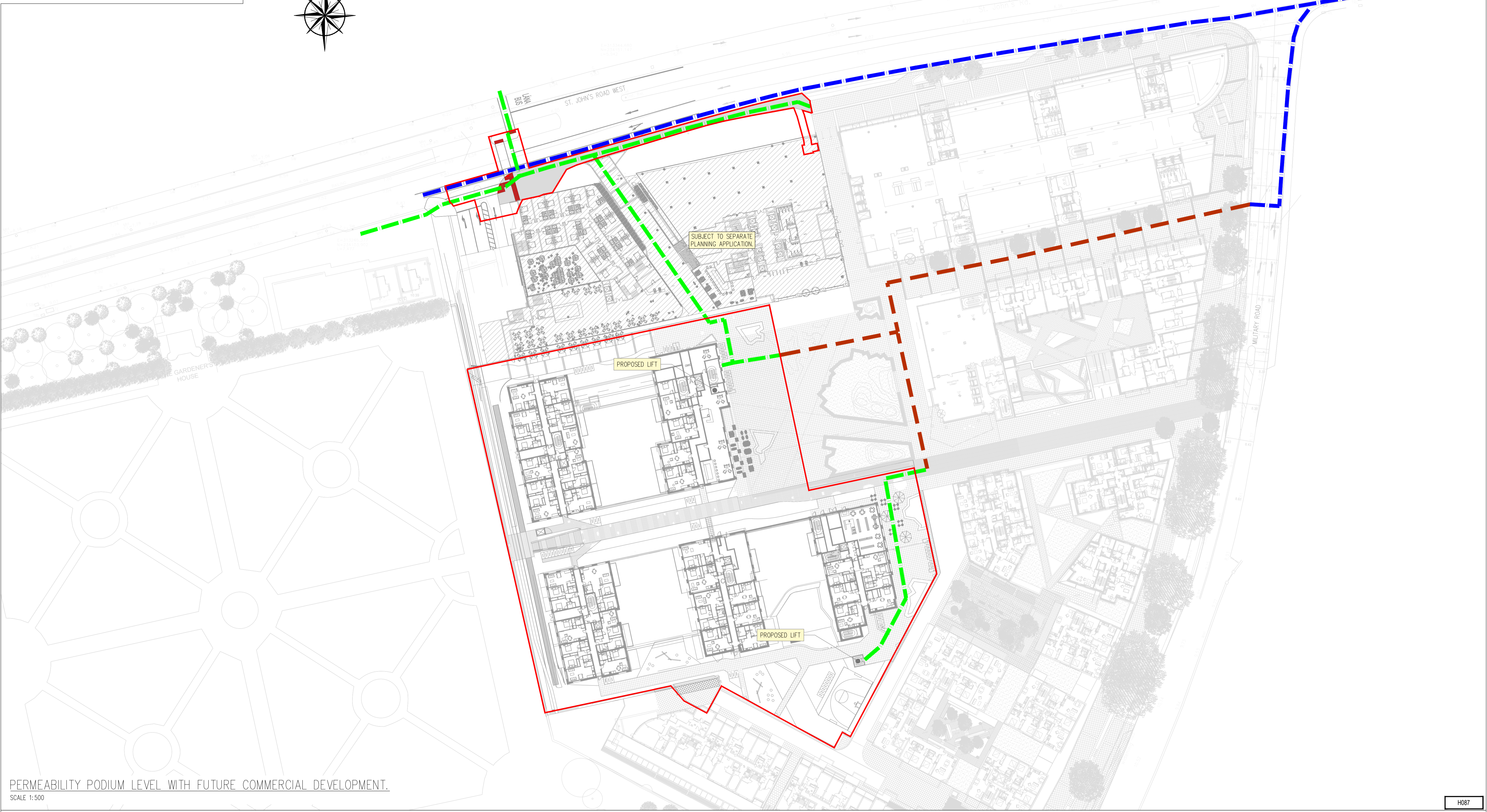
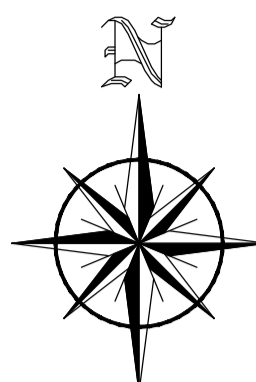

PERMEABILITY PODIUM LEVEL WITH FUTURE COMMERCIAL DEVELOPMENT.
SCALE 1:500

PLANNING DRAWING.
NOT FOR CONSTRUCTION.
 ALL LEVELS GIVEN ARE
 RELATIVE TO ORDNANCE DATUM.
 THIS DRAWING HAS BEEN ISSUED FOR INFORMATION
 PURPOSES ONLY AND MUST NOT BE USED
 FOR CONSTRUCTION UNDER ANY CIRCUMSTANCES

- NOTES**
- For setting out refer to Architect's drawings.
 - This drawing to be read in conjunction with all other Architectural and Engineering drawings and all other relevant drawings and Specifications.
 - DO NOT SCALE THIS DRAWING. Use figured dimensions only.
 - No part of this document may be reproduced or transmitted in any form or stored in any retrieval system of any nature without the written permission as copyright holder except as agreed for use on the project for which the document was originally issued.
 - Ordnance Survey Ireland Licence Number EN 0074021

Rev. No	Date	REVISION NOTE	Dim. By	Chkd. By
P1	17.09.2021	ISSUED FOR PLANNING STAGE 3	JS	GF

Architect	Reddy Architecture
Project	HEUSTON SOUTH QUARTER, ST. JOHN'S ROAD WEST, KILMAINHAM
Title	PERMEABILITY PODIUM LEVEL WITH FUTURE COMMERCIAL DEVELOPMENT
Dwg. No.	HSQ-CSC-XX-XX-DR-C-0118
Date	JULY 2021
Dim by	JS
Chkd by	NB
Aprvd by	DR
Scale	1:500 @ A1
Revision	P1

CS Consulting Group
 DUBLIN | LONDON | LIMERICK

Head Office
 19-22 Dame Street, Dublin 2.
 T: +353 (0)1 5480863 F: +353 (0)1 9011355
 e: info@csconsulting.ie
 w: www.csconsulting.ie

Quality Environment I.S. EN ISO 9001:2008
 Energy I.S. EN ISO 14001:2004
 Health & Safety OHSAS 18001:2007

